

## SPINNER SIGN HOLDER

- Bolt sign holder assembly to base by inserting two 5/16" -18x3" **Truss Head Bolts** through the holes in the bottom of the sign holder making sure they project downward. (Fig. 1)
- Locate the round recesses on the bottom of the **Wheelee™** base, line up the bolts, then add the **Fender Washers, Lock Washers** and **Wing Nuts**. (Fig. 1)
- Tighten the wing nuts making sure the sign holder sits in the recess in the top of the base. The nuts should be very tight to prevent the sign from moving.

## SIGN PANEL

- Attach the **Air Scoops** to the decorated sign panel by pressing the **Air Scoops** onto the edge of the sign panel making sure they are fully seated and oriented in opposite directions.
- Secure the **Air Scoops** to the sign face using the 2" stainless steel **Grip-All Screws** through the pre-drilled holes (Fig 2). **DO NOT OVERTIGHTEN.**
- Place the **Stepped Bushing** over the stainless steel Pivot Pin on the bottom of the sign holder followed by the **Nylon Thrust Bearing** (Fig 3).
- Mark the center hole in the top and bottom of the sign panel and insert the **U-Channel Bushings** before placing the sign on the bottom **Pivot Pin** (Fig 3).
- Insert the stainless steel **Top Pivot Pin** through the hole in the top of the sign holder and align with the **U-Channel Bushing** before tightening. You may need to add the **Nylon Washer** as a spacer (Fig 4).

## HELPFUL HINTS

- Use bold graphics with contrasting colors on each side for flashing effect.
- To transport, tip sign and use top of sign holder to pull or push.
- To empty ballast (water, sand, etc.) remove ballast caps and pour out material. Replace ballast cap.
- Sand or small pea gravel works best for ballast and offers the most weight.
- **SPINNER™** Signs are designed for winds up to 25+ mph. In the event of higher winds bring sign inside.



**Joseph Struhl Company, Inc.**  
195 Atlantic Ave., PO Box N, Garden City Park, NY 11040  
1-800-552-0023 • 516-741-3660 • Fax 516-742-3617  
[www.magicmaster.com](http://www.magicmaster.com)



**SPINNER™ Rotator Sign  
USER GUIDE**

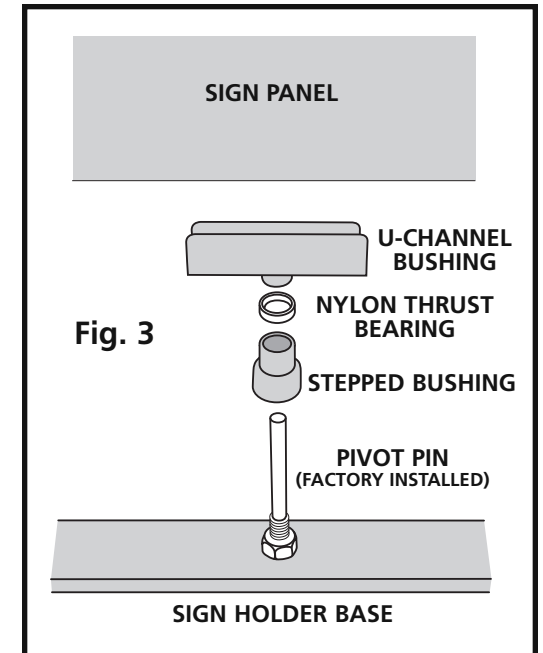
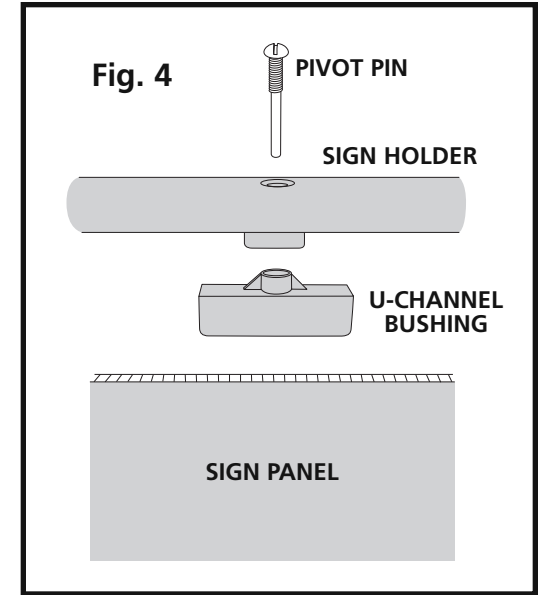
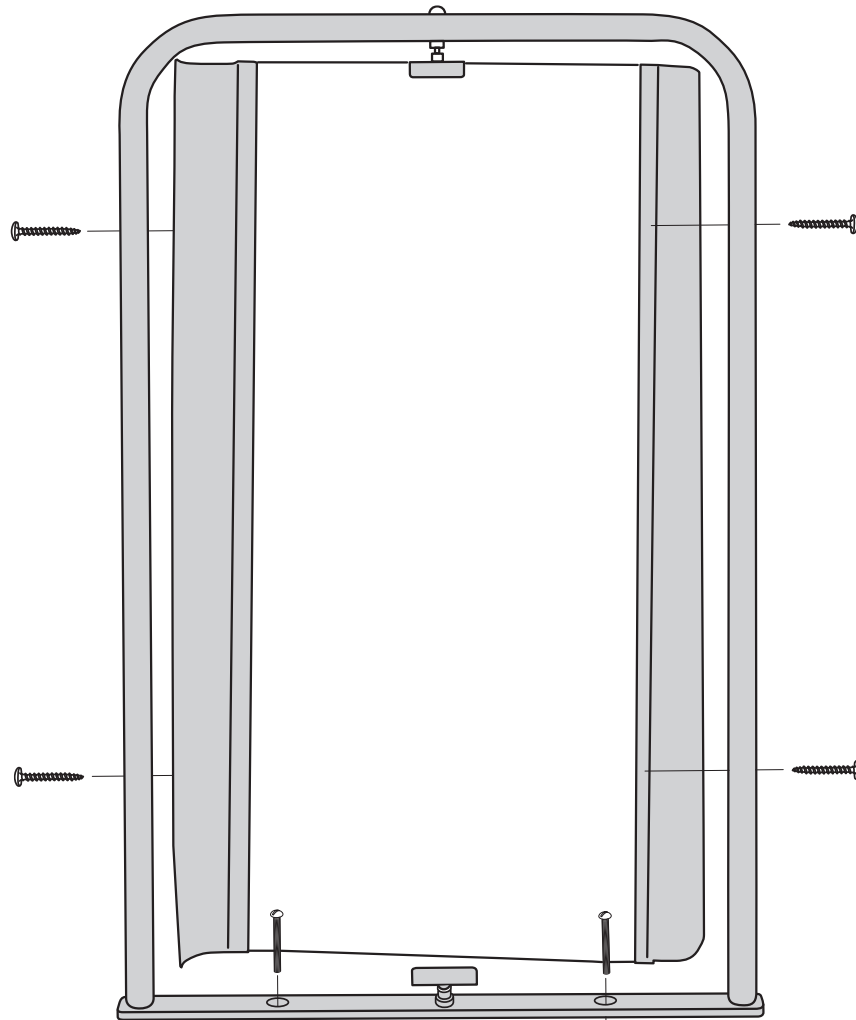
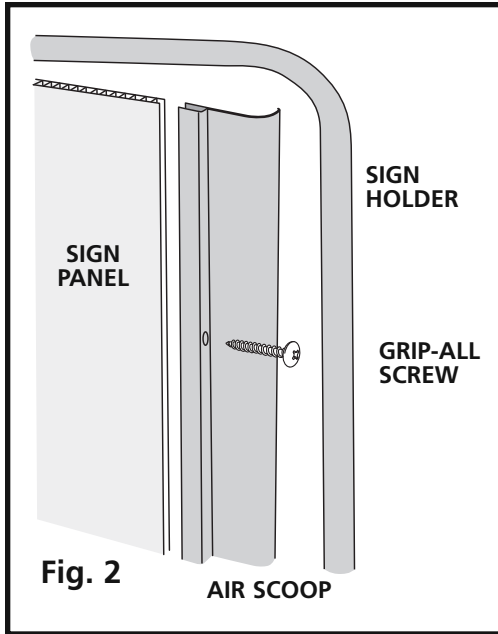

**ASSEMBLY ORDER**

1. Attach Sign Holder to Base (Fig 1.)
  2. Decorate Sign Face.
  3. Install Air Scoops (Fig. 2)
  4. Attach completed sign panel (Fig 3, 4)
- See directions on page 4.

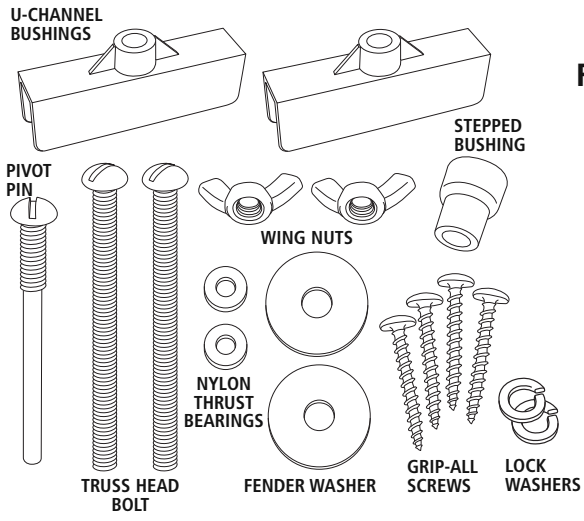

**Fig. 1**